

KL8-296, KL8-259 DYNAMO INDUSTRIAL INDUSTRIAL TWO EIGHT FOOT LAMPS

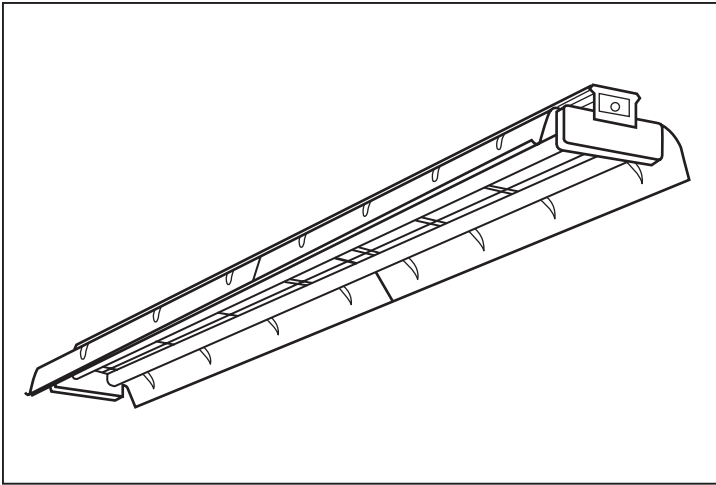

Type: _____

Job Description: _____

FEATURES:

- Reflectors have 15% uplight.
- Spring loaded turret lampholders.
- 6" lamp spacing.
- For individual or continuous row mounting.
- Channel ends double as joiners.
- Reflector end closures available

SPECIFICATIONS:

Housing

Heavy steel with longitudinal reinforcing ribs for extra strength.

Reflector

Die embossed with transverse ribs for maximum rigidity. Smooth extruded apertures for 15% uplight.

Ballasts

Energy efficient, thermally protected, automatic resetting, Class P, high power factor, CBM, unless otherwise specified.

Finish

All parts pre-painted with high gloss baked white enamel, minimum reflectance 86%, applied over iron phosphate pre-treatment for maximum adhesion and rust resistance.

Labels

All fixtures carry the U.L. label. (CSA approval available. Use Suffix "CSA").

Cross Section

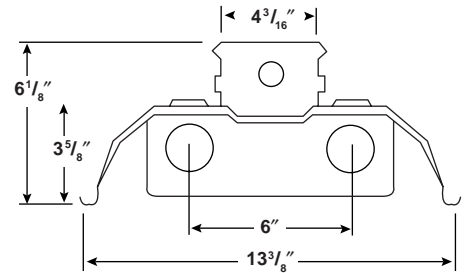
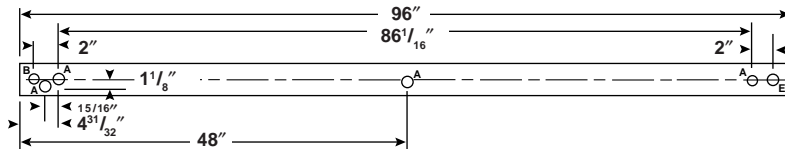

A - 7/8" Diameter Knockout

B - .570" x .656" Strain Relief Knockout

E - 1-1/8" Diameter Knockout

Note: All dimensions are in inches; dimensions are subject to change without notice. Please consult factory or check sample for verification.

Mounting Accessories

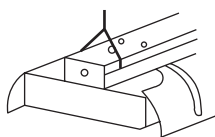

KHC

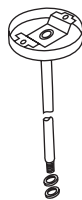

S18

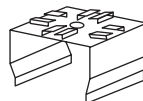

KZTF

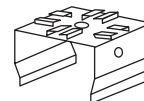

KZT

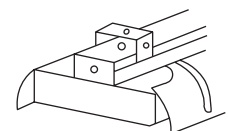

KTH



Tel 509 924 7000
PO Box 2787 (99220) 9808 North Sullivan Road Spokane WA 99216

Environmental Laboratories

REPORT # 10241
DATE: 10/ 9/92

LUMINAIRE: KLB-296-PAF

1 X 8 2-L INDUSTRIAL W/APERTURED BAKED WHITE ENAMEL REFLECTOR
BAL.: B06-BR-TC-P; LAMPS: F96T12/CW; BF: .95; WATTS: 170
LAMPS RATED AT 6150 LUMENS EACH
LUMINOUS AREA: 96 X 12.25

REFLECTANCE: BME .88

MOUNTING: PENDANT

S/MH: PARL 1.28 NORM 1.29

SHIELDING: PARL 5 NORM 15

DEG	0	22.5	45	67.5	90
0	2954.	2954.	2954.	2954.	2954.
5	2939.	2937.	2930.	2906.	2894.
15	2843.	2806.	2782.	2766.	2757.
25	2653.	2592.	2596.	2597.	2591.
35	2373.	2314.	2348.	2363.	2377.
45	2010.	1972.	2040.	2167.	2208.
55	1577.	1570.	1764.	1777.	1771.
65	1084.	1154.	1750.	1288.	1304.
75	576.	487.	838.	856.	803.
85	133.	188.	182.	193.	197.
90	15.	67.	89.	97.	100.
95	37.	71.	96.	112.	115.
105	145.	64.	146.	211.	212.
115	335.	133.	88.	109.	116.
125	538.	238.	150.	109.	105.
135	731.	362.	261.	208.	192.
145	872.	534.	388.	332.	318.
155	948.	728.	544.	475.	464.
165	993.	915.	801.	740.	732.
175	977.	1027.	1019.	1021.	1038.
180	1051.	1051.	1051.	1051.	1051.

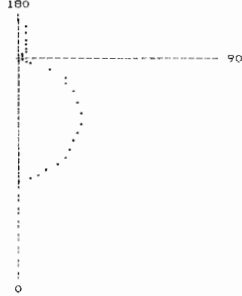

ZONE	LUMENS	LAMP	FIXT
0- 30	2265.	18.4	21.0
0- 40	3738.	30.4	34.6
0- 60	6847.	55.7	63.4
0- 90	9071.	73.8	84.0
90-120	391.	3.2	3.6
90-130	578.	4.7	5.4
90-150	1116.	9.1	10.3
90-180	1728.	14.0	16.0
0-180	10799.	87.8	100.0

This photometric test was performed using a specific ballast / lamp combination. Extrapolation of these data for other ballast / lamp combinations may produce erroneous results. The ballast factor must be applied to the lumen output rating assigned to the lamp(s) or to the candlepower values shown. Luminaire efficacy rating (LER) per NEMA LE5-1993.

LER = F1- 60

TESTED BY: *R.K.* APPROVED BY: *[Signature]*

TEST RUN IN ACCORDANCE TO CURRENT I.E.S. PUBLISHED PROCEDURES

Coefficients of Utilization

Zonal Cavity Method

Floor Reflectance - .20

RC RW	80				70				50				0
	70	50	30	10	70	50	30	10	50	30	10	0	
1	92	88	85	81	89	85	82	79	79	76	74	63	
2	84	77	71	66	81	74	69	65	69	65	61	52	
3	77	68	61	55	73	65	59	54	61	56	51	44	
4	70	60	53	47	67	58	51	46	54	48	44	37	
5	64	53	45	39	61	51	44	38	48	41	37	31	
6	59	47	39	34	56	46	38	33	43	36	32	27	
7	54	42	35	29	52	41	34	29	38	32	27	23	
8	50	38	30	25	48	37	30	25	34	28	24	20	
9	46	34	27	22	44	33	26	21	31	25	20	17	
10	43	31	24	19	41	30	23	19	28	22	18	15	

Coefficients of Utilization

Energy Data

LER: F1-60
Input Watts: 170

Energy Cost: \$4.00*
BF: .95

The above energy calculations were conducted using a specific lamp/ballast combination. Actual results may vary depending upon the lamp and ballast used. Lamp and ballast specifications are subject to change without notice.

*Comparative annual lighting energy cost per 1000 lumens based on 3000 hours and \$0.08 per KWH.

Ordering Information

Example: KL8-296-LE120

Series

KL

Size

8 - 8'

No. of Lamps in Cross Section

2 - Two

Lamp Type

96 - 96" T12, Slimline
59 - 59 Watt, 96" T8

Reflector Type

Blank - Apertured Reflector for Uplight (Standard)
ST - Solid Top (No Uplight)

* Not for use with energy saving lamps.
For complete list of options and accessories, see options and accessories section.

Ballast

- LE - Energy Saving Magnetic T12 (8' only)
 - Z - Zero Degree Magnetic T12*
 - EB12 - Electronic T12
 - EB12LH - Electronic T12 <10% THD
 - EB8 - Electronic T8
 - EB8LH - Electronic T8 <10% THD
- For a specific ballast vendor, show as option

Voltage

- 120 - 120V
- 277 - 277V
- 347 - 347V

Industrial Options

- GLR - Fast Blow Fuse
- GMF - Slow Blow fuse
- EL - Emergency Battery Pack
- BC - Branch Circuit Plug-on Wiring System (See options section for details.)
- CSA - Approved, Canadian Standards Association
- PAF - Paint After Fabrication

Industrial Accessories

Order Separately

- KZTF - Zip Tee Hanger - flush mounting on tee bar ceiling
- KZT - Zip Tee Hanger - 1-1/2" spacer on tee bar ceiling
- KTH - Slide Clamp Tong Hanger
- S18 - 18" Stem, canopy and 8° aligner
- SS18 - 18", 45° Swivel Stem & Canopy
- KHC - 24" Chain Hanging Assembly
- KLEC - Reflector end closure
- KLWG4 - Wire Guard 4' lg. - 2 required per 8' fixture